

specifications

TYPE	Freehold Townhouse
LEVELS	2
YEAR BUILT	2000
SQUARE FEET	1375 sq.ft.
BEDROOMS	3
BATHROOMS	
4 Piece Baths	1
2 Piece Baths	1
LAUNDRY	Basement

DRIVEWAY PARKING	2
GARAGE PARKING	1
2020 PROPERTY TAX	\$3,535
LOT	Frontage: 22.97 feet Depth: 115.95 feet
FRONT EXPOSURE	East
EST. RENTAL INCOME	\$2,400

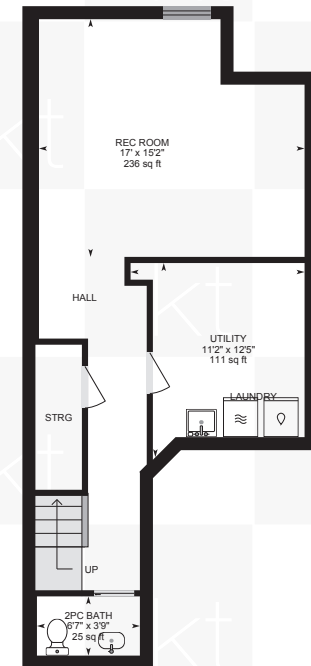
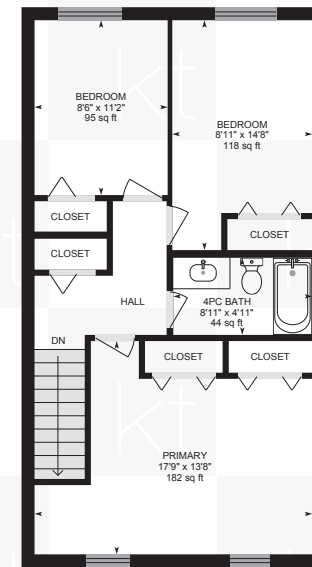

44 KING WILLIAM COURT

Measurements and calculations are approximate
To be used as guidelines only



*Room sizes, year built, lot dimensions, taxes and all other specifications are approximate.
Square footage source: Floorplan. Buyers and/or their agent are responsible for determining exact figures.